

GOMIC EX

"GOMIC EX" Rotary Drum type Refuse Storage System

GMN-8000
GMN-18000

NEW



CLEAN

COMPACT

COST
PERFORMANCE

The target we have been aiming is the "Cleanness" of refuse collection point. "GOMIC EX" will definitely change the image of refuse collection point. Your effort for environment will be appreciated by the people, who wish to be environmentally friendly.

The target we have been aiming is the "Compactness" of design. Based on over 20 years experience of manufacturing and maintenance, New Rotary Drum type Refuse Storage system "GOMIC EX" is now introduced. This compact new system contains well-prepared & high level-function. So that, user can save a lot of space by this "GOMIC EX".

The target we have been aiming is "Cost performance" and "Durability". This "GOMIC EX" can give great cost saving about purchasing, running and maintenance.

System

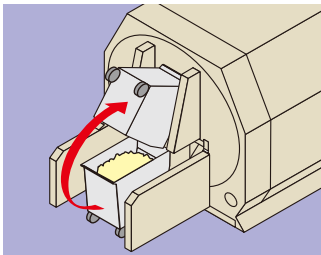

1 Refuse insert
After opening inlet gate shutter, rotation of drum starts and 240L refuse bin is lift up and turn over by T.O.E. without any human work, so refuse is intaken into drum inside automatically.

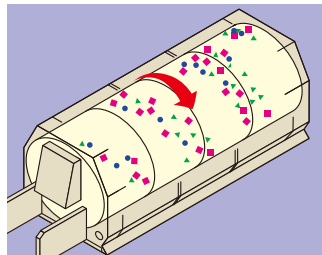

2 Drum rotation
Intaken refuse is broken and agitated and refuse will be homogenized.

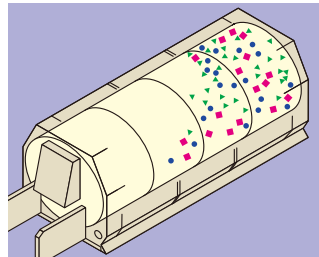

3 Compressed & Stored
By drum rotation, refuse is transferred to discharge side & compressed and hold.

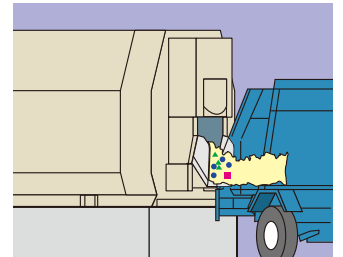

4 Auto Discharge
Hold refuse is automatically discharged by drum rotation after opening discharge gate and transferred to RCV by chute without any additional human work.

Clean Refuse treatment is now needed for better environment & better image of users.

"GOMIC EX" will give your best cost saving performance.

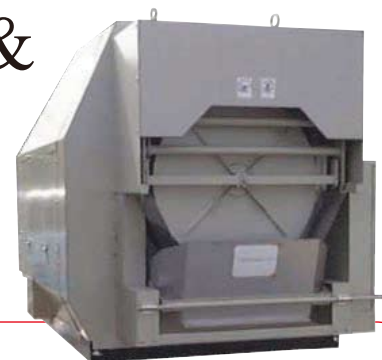

Dimension and necessary area

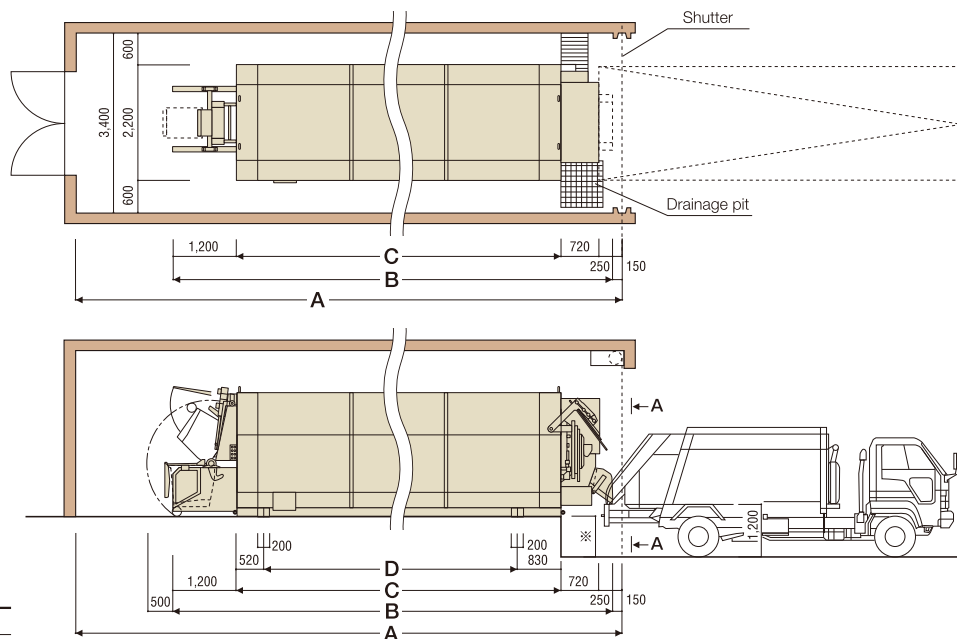
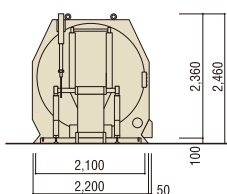
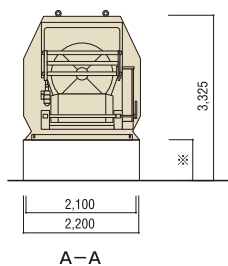

Dimension	A	B	C	D
GMN-8000EX	7,200	5,031	2,861	1,511
GMN-18000EX	10,500	8,348	8,178	4,828

※ This height is decided according to RCV tailgate height.

Basic Specification of GOMIC EX

Model No.	GMN-8000EX	GMN-18000EX
Main Spec.	Rotary Drum Refuse Storage System	
Net Capacity	8.0m ³	18.0m ³
Holding Capacity (Compression Ratio: 1.5)	approx.12.0m ³	approx.27.0m ³
Drum	Rotary Drum type	
a) System	Rotary Drum type	
b) Diameter	1,940mmφ	
c) Material	Stainless Steel (=SUS304), 3.0mm(T)	
d) System	Roller Chain Drive	
e) Rotation	3.5r.p.m.(50Hz) / 4.3r.p.m.(60Hz)	
f) Chain	JIS #120-1 Roller Chain	
g) Motor	3ph, AC200V, 2.2KW i=1/45	3ph, AC200V, 7.5KW i=1/45
h) Inner Fins	Independent 3 different size	
i) Drum Bearing Rings	Seamless Cold Forged, Heat Tempered Steel = JIS G4051 Hardness : HB179-217	
Discharge		
a) Capacity	0.5~1.5m ³ /min	
b) System	Link type open / close, max. opening : 720mm	
c) Drive	Electric Cylinder 3ph, AC 200V, 0.3KW	
d) Gate	1,172mmφ, Center Bearing with 10mm(T) CR Rubber seal	
e) Chute System	Combination of fix & movable parts	
f) Chute Material	Stainless Steel (=SUS 304)	
Inlet		
a) Inlet Gate	Manual Vertical type	

	GMN-8000EX	GMN-18000EX
Turn Over Equipment (T.O.E.)		
a) Drive	Electric Cylinder, 3ph, AC 200V, 0.6KW	
b) Refuse Bin	0.24m ³ / Plastic Bin	
c) Capacity	Max. Gross Weight : 200Kg	
d) Turning Angle	135°	
Base Frame		
a) Construction	Square Shape Pipe with 20mm(T) Vibration Free Rubber	
b) Material	SS400 STKR400	
Painting		
a) Base Frame	Base Coat : Synthetic Polymer Antirust Paint Over Coat : Nipple Uni-Pack 400D Black	
b) Outside	M/M 40μ Powder Electric Static Coat Paint, Beige Colour	
Control Box		
a) System	Water and Dust Resistant Cabinet Box with Lock, Push Buttons, Lights	
b) Size	200 × 1230 × 500mm	
c) Capacity	3ph AC : 200V, 2.5KW 2ph AC : 100V, 0.5KW	3ph AC : 200V, 8.4KW 2ph AC : 100V, 0.5KW
d) Power Supply	6.7KVA	14.7KVA
Detect	Full Warning Lump by Current Level, Drum Rotation Stop	
Inlet Gate Control	Control Buttons, Emergency Stop Buttons & Lump, Full Warning Lump	
Weight		
a) Machine	3,950Kg	5,400Kg
b) T.O.E.	300Kg	300Kg
c) Max. Weight (Refuse Gravity : 0.25)	approx. 6,950Kg	approx. 12,150Kg